



Vista Pivot[™]



IMPACT & NON-IMPACT RATED
Pivot Doors



#22410



An Innovative Spin on Doors



Make an architectural statement and a grand entrance with our Vista Pivot™ doors. These unique doors deliver massive style, while taking up little space, since they rotate within their own footprint. Choose from sleek, stunning aluminum or warm, rich wood clad interior finishes. Vista Pivot™ can be constructed to a height of 14' and a width of 100", providing breathtaking solutions for any commercial or residential application.

At Euro-Wall, everything we do is Superior by Design. We constantly push ourselves to provide the highest quality doors with the largest views to give you the freedom to design without limitations.



Features & Benefits

Fully Flush Thresholds

Don't get tripped up. No sills are necessary, providing a smooth, seamless entry.

Matching Fixed Units

Complement your aesthetic with available impact-rated transom and sidelight units.

Massive Panel Sizes

Enjoy the view through up to 168" tall / 100" wide panels with both impact and non-impact ratings.

Beauty & Flexibility

Customize your door with many options for muntins, simulated divided lites, mid-rails, wood and aluminum cladding.

Long-Lasting Finish

Take in the beauty for years. Our standard finish coating meets the AAMA 2605 high-performance specification, the highest quality finish available.

System Thresholds

MAXIMUM / MINIMUM SPECIFICATIONS

	IMPACT / NON-IMPACT
MAX. PANEL WEIGHT	700 lbs
MAX. PANEL HEIGHT	168"
MAX. PANEL WIDTH	100"
MIN. PANEL HEIGHT	48"
MIN. PANEL WIDTH	36"
PANEL THICKNESS	2-1/4"

Note: The Vista Pivot™ door comes in aluminum, aluminum with interior wood clad, or an interior / exterior faux woodgrain finish. The Vista Pivot™ door can be configured as either an outswing or an inswing. For installations in Florida, please see the Florida Product Approval (#24410) for usage and limitations.

**10
YEAR
LIMITED**

WARRANTY

10-Year Limited Warranty

Euro-Wall warrants the products to be free from manufacturing defects for a period of 10 years.



System Components

- 1 Top Pivot Hinge
- 2 Handle Option 1
LADDER PULL & THUMB BOLT
- 3 Handle Option 2
MULTI POINT HANDLE
- 4 Bottom Pivot Hinge



Finish Options

INTERIOR WOOD CLAD FINISHES



Mahogany / Sapele

White Oak

STANDARD FRAME & ALUMINUM PANEL FINISHES



White

Sunstorm Arcadia Silver

Bronze

Black



Clear Anodized

- Powder coat or Kynar® finishes available
- Custom powder coat or Kynar® finishes available

FAUX WOOD GRAIN FINISHES

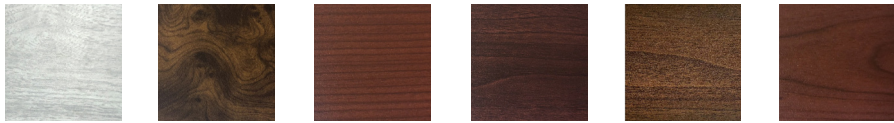

Aspen

Burlwood

Chesnut Cherry

Cinnamon Red

Dark Walnut

Mahogany Red



Natura

English Oak

Teak

Walnut Brown

Hazelnut Brown

Honey Pine

EXOTIC WOOD FINISHES



African Rosewood

Ash

Birch

Curly Maple



Red Oak

Walnut

Zebrawood

Additional exotic wood finish options available upon request.

A faux wood finish is a powder coat with die sublimation to an AAMA 2604 finish qualification. Additional faux woodgrain options available upon request.

Door Panel Options

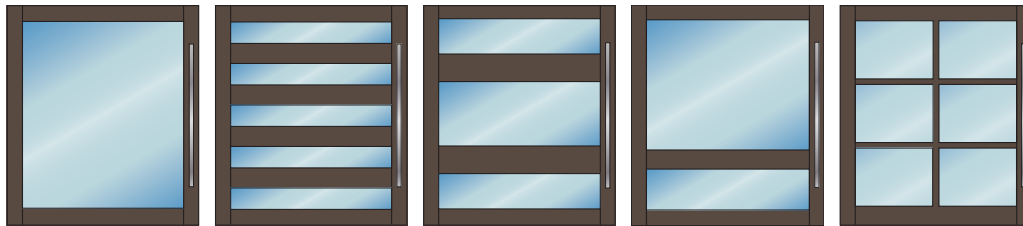

1 2 3 4 5



6 7 8 9 10

Note: Natural wood clad available for interior finishes. Faux woodgrain painted finishes available for interior & exterior use.

Hardware / Handle Finish Options

LADDER PULL HANDLE (STANDARD)



Ladder Pull Sizes up to 8' Tall

- Black
- Bronze
- Brushed Satin
- Polished Stainless Steel
- White

MULTIPOINT LOCK HANDLE



- Black
- Bronze
- Brushed Satin
- Polished Stainless Steel



Top View - Horizontal Cross Section

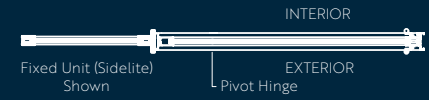

LEFT HAND INSWING

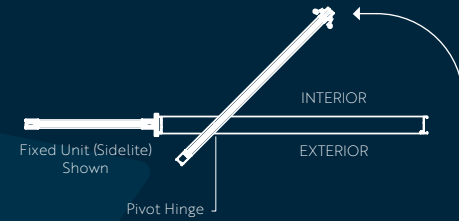

LEFT HAND OUTSWING

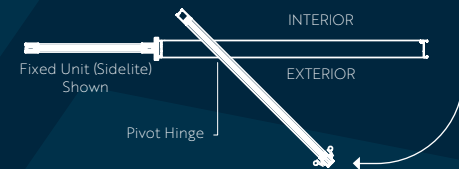

SINGLE FRAME MULTI PIVOT

Only Available in Non-Impact Conditions

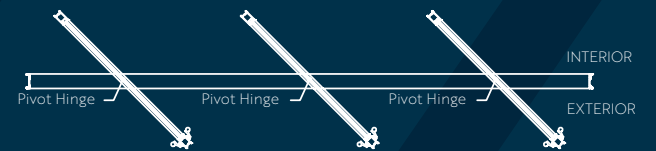

Note: Right hand inswing and right hand outswing are also available

Optional Drainage System

Euro-Wall offers an optional water management system that allows water to drain away from the pivot door location.

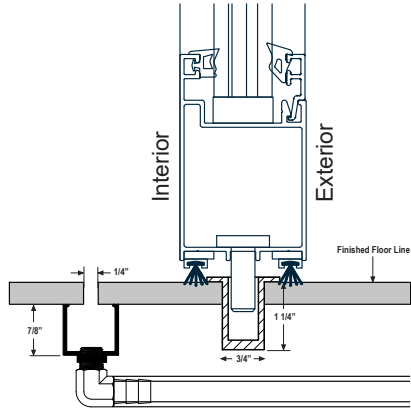

Glazing Details

OVERALL GLASS THICKNESS 1/4" | 3/8" | 1/2" | 9/16" | 1"

We can handle most any type of glass if it meets the required thickness. *Let's talk.*

9/16" LAMINATED - IMPACT RATED

Stile

Top Bottom Rail

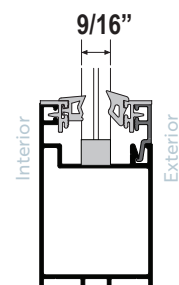
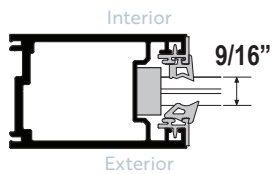

1" INSULATED GLASS - IMPACT RATED

Stile

Top Bottom Rail

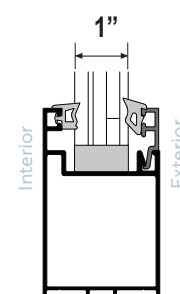
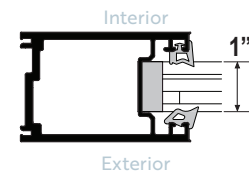

Panel Cross Section

Outswing Configuration
1" Insulated Impact Glass Shown

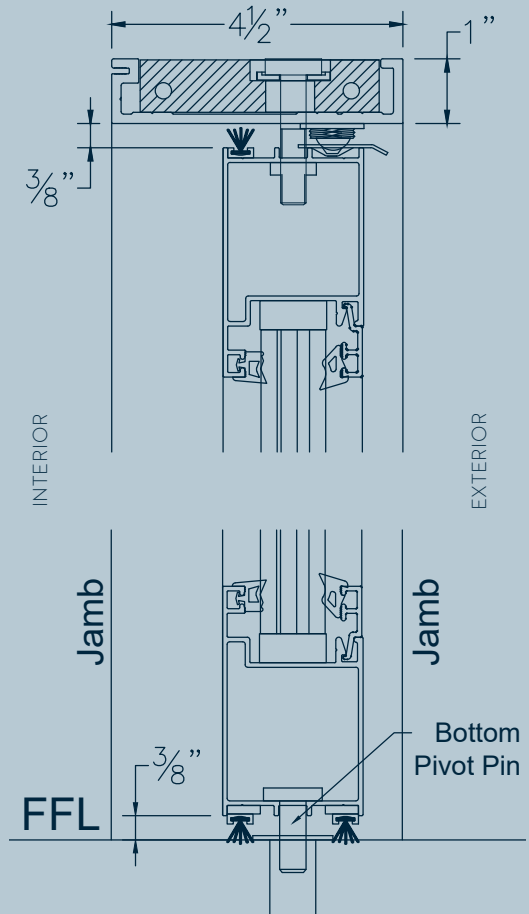



DESIGN PRESSURE CHARTS

HVHZ & Wind Zone 3

		Unit Width											
		60	64	68	72	76	80	84	88	92	96	100	
Panel Height	72	60	60	60	60	60	57	54.55	52.5	50.77	49.29	48	HVHZ
	78	60	60	60	60	60	56.84	54.03	51.69	49.73	48.07	46.64	
	84	60	60	60	60	60	56.84	54	51.43	49.19	47.31	45.71	
	90	60	60	60	60	60	56.84	54	51.43	49.09	46.98	45.18	
	96	60	60	60	60	60	56.84	54	51.43	49.09	46.96	45	
	102	60	60	60	60	60	56.84	54	51.43	49.09	46.96	45	
	108	60	60	60	60	60	56.84	54	51.43	49.09	46.96		
	114	60	60	60	60	60	56.84	54	51.43				
	120	60	60	60	60	60	56.84	54					
	126	60	60	60	60	60	56.84						
	132	60	60	60	60	59.87							
	138	60	60	60	60								
	144	60	60	60	60								
	150	60	60	60									
	156	60	60										
162	60	60											
168	60												

Test Performance

IMPACT

Air Infiltration: ASTM E283-04

Water Infiltration: ASTM E331-00

Wind Load: TAS 202-94

Large Missile Impact: TAS 201-94

Cyclic Load: TAS 203-94

Forced Entry: AAMA 1304-18

Non-Impact

		Tributary Width										
		60	64	68	72	76	80	84	88	92	96	100
Panel Height	72	60	60	60	60	60	60	60	60	60	60	60
	78	60	60	60	60	60	60	60	60	60	60	60
	84	60	60	60	60	60	60	60	60	60	60	60
	90	60	60	60	60	60	60	60	60	60	60	60
	96	60	60	60	60	60	60	60	60	60	60	60
	102	60	60	60	60	56.8	55.4	55.4	55.4	55.4	55.4	55.4
	108	60	60	60	60	56.8	54	51.4	51.4	51.4	51.4	
	114	60	60	60	60	56.8	54	51.4	49.1			
	120	60	60	60	60	56.8	54	51.4				
	126	60	60	60	60	56.8	54					
	132	60	60	60	60	56.8						
	138	60	60	60	60							
	144	60	60	60	60							
	150	60	60	60								
	156	60	60									
162	60	60										
168	60											



#22410



NEED *assistance?*

If you have questions about Vista Pivot™ that have you spinning, don't worry. Our FOR YOU Crew™ is always ready to clear things up with friendly, one-on-one support.





euro-wall.com



American Made.
EUROPEAN INSPIRED.

MANUFACTURING & SHOWROOM

2200 Murphy Ct.
North Port, FL 34289
888.989.EURO (3876)

SHOWROOM

1211 Stirling Rd., Unit 102,
Dania Beach, FL 33004
941.979.5316

EURO-WALL UNLOCKS *brehtaking perspectives*
THROUGH THE *largest, strongest* DOOR SYSTEMS
WITH THE MOST DESIGN OPTIONS – ALL BACKED
BY *enjoyable, personal* SUPPORT – FOR A *superior*
experience FROM OPEN TO CLOSE.

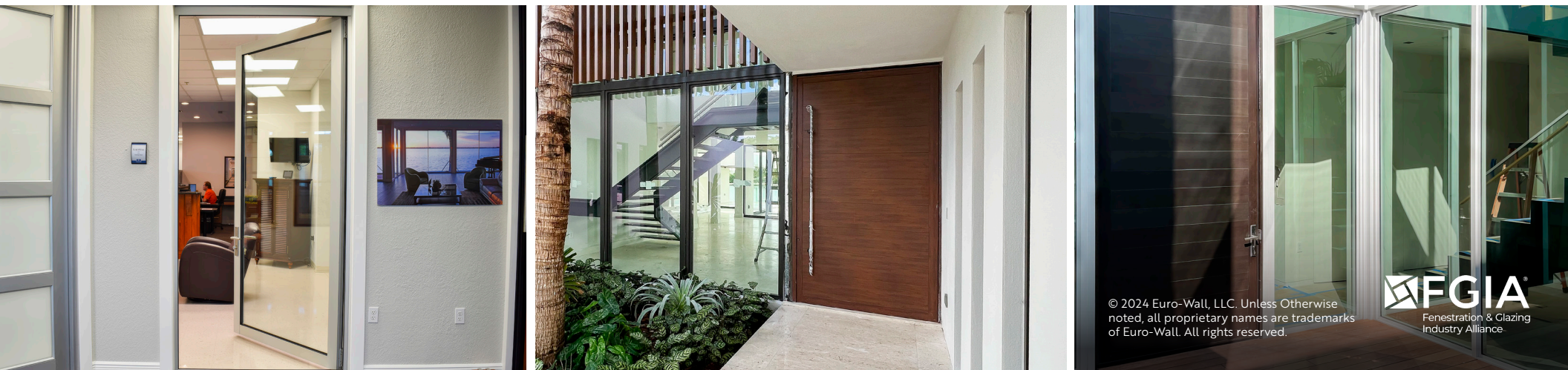

© 2024 Euro-Wall, LLC. Unless Otherwise noted, all proprietary names are trademarks of Euro-Wall. All rights reserved.

